

# ***Continental Cabinets***

Continental "U" Avalon



## *Features:*

- ALL WOOD CONSTRUCTION • 1/2" PLYWOOD SIDES
- 3/4" SOLID OAK FACE FRAMES • EURO/CONCEALED HINGE
- 5/8" ADJUSTABLE PLYWOOD SHELVES • DRAWER BOX w/1/2" PLYWOOD SIDES
- EPOXY COATED DRAWER GLIDES • RAISED PANEL OAK DOORS
- 4-1/2" TOE SPACE with ALL WOOD TOE KICKS



## WALL CABINETS 12" DEEP

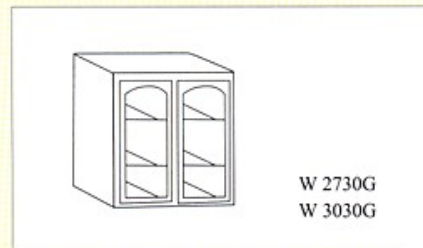
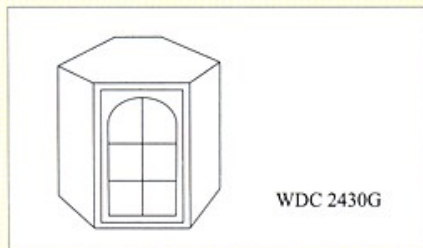
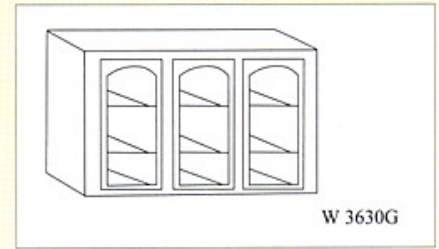
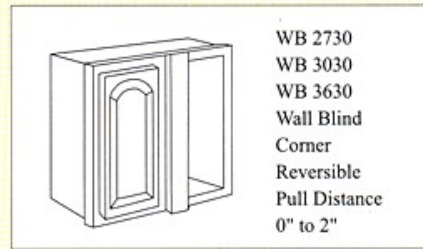
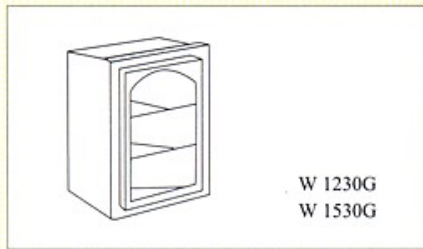
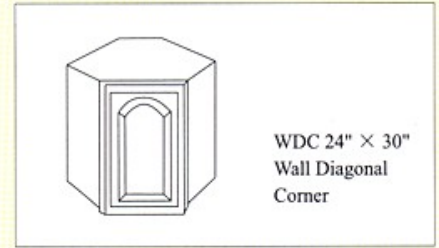
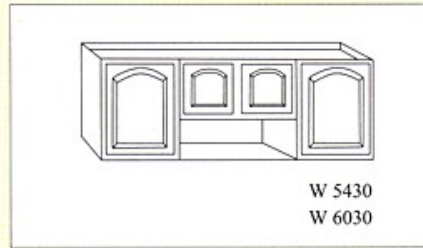
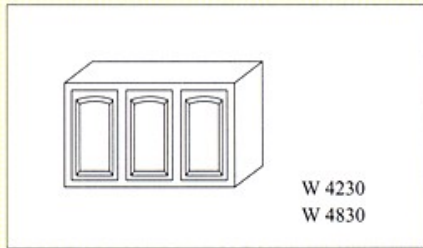
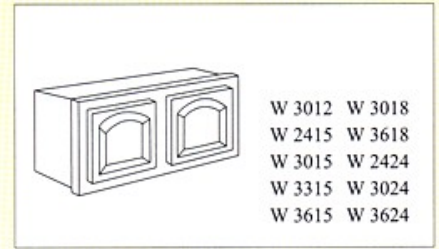
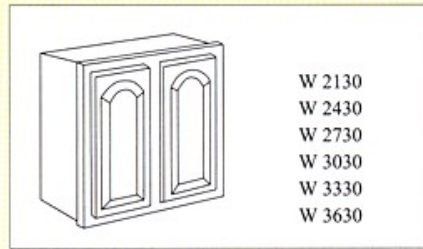
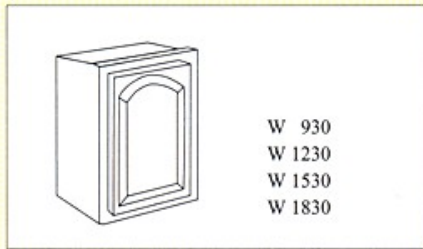

## BASE CABINETS 34 - 1/2" HIGH & 24" DEEP

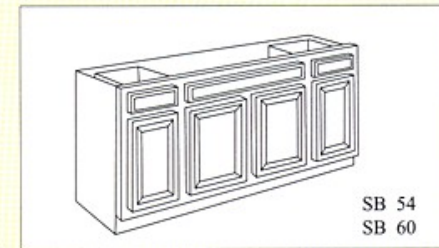
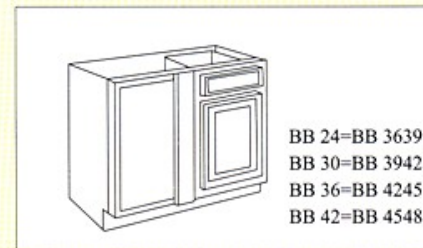
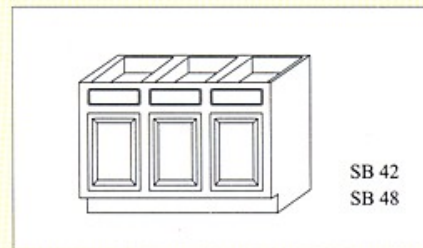
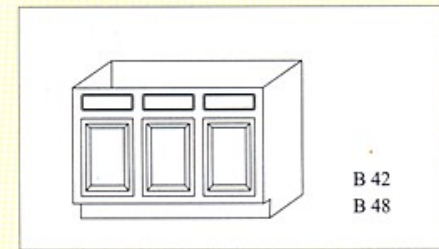
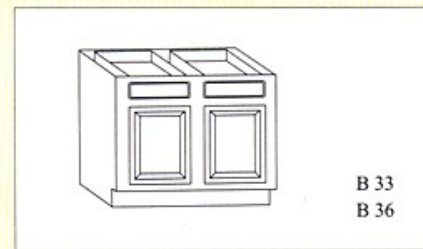
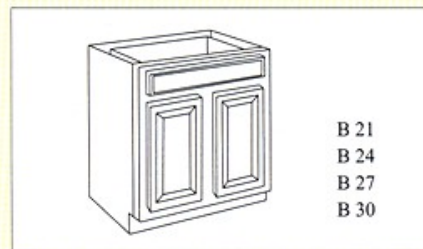
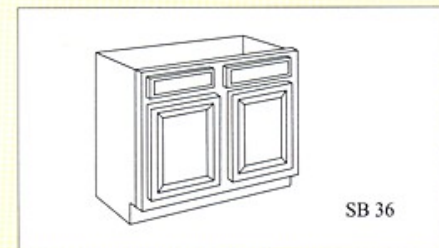
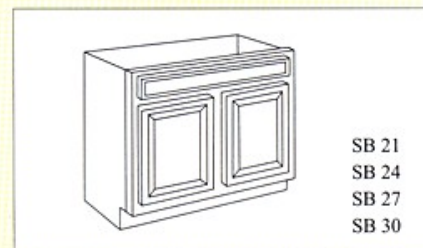
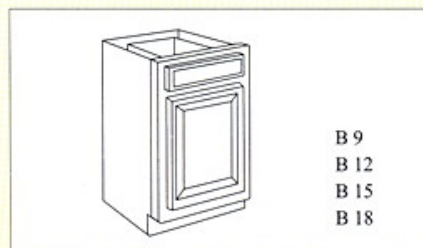



## TALL CABINETS (84" HIGH)

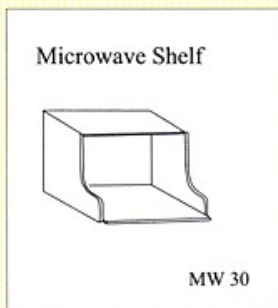
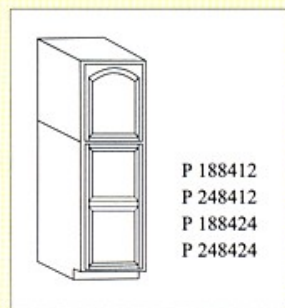

## BASE CABINETS 34 - 1/2" HIGH & 24" DEEP

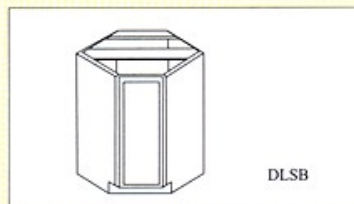
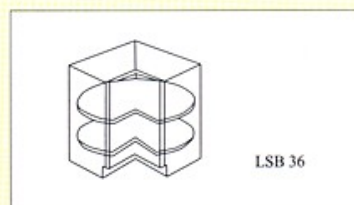
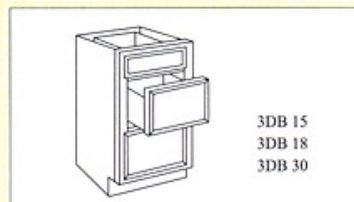

## VANITIES

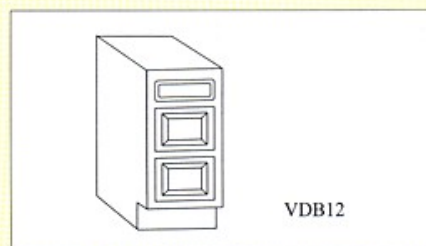
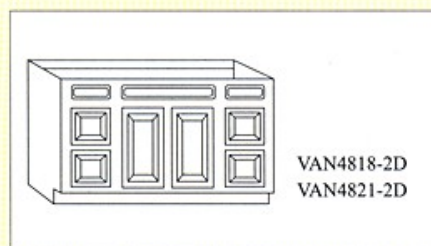
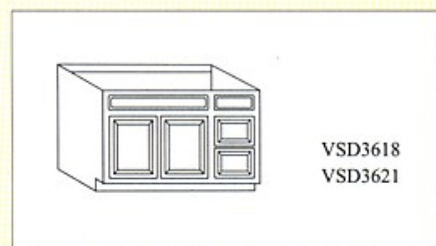
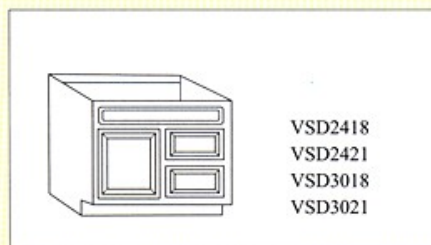
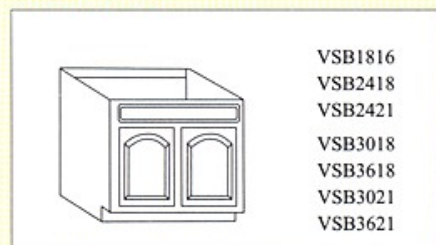

## SPECIALTY UNITS

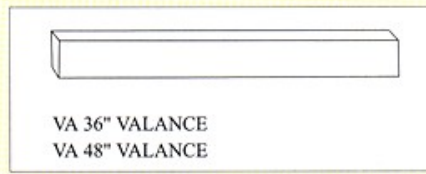
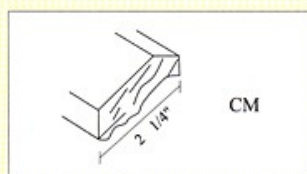
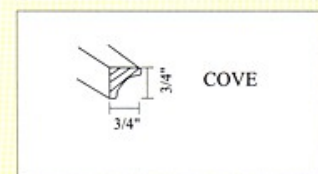
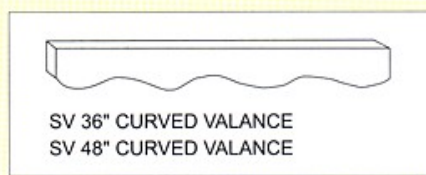
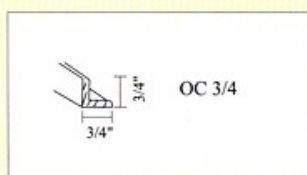
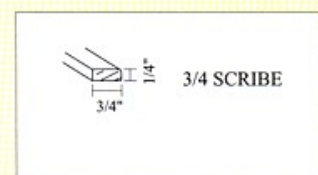
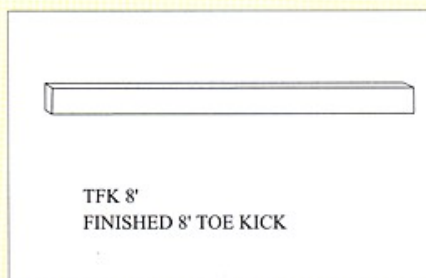
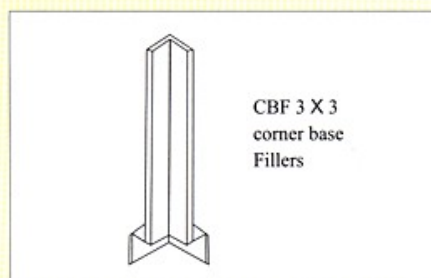
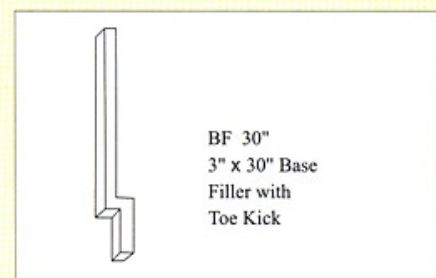
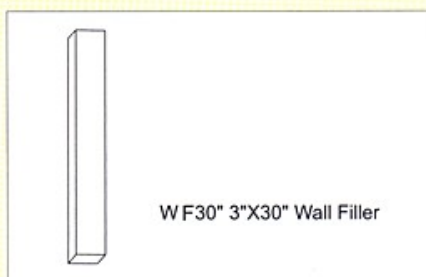
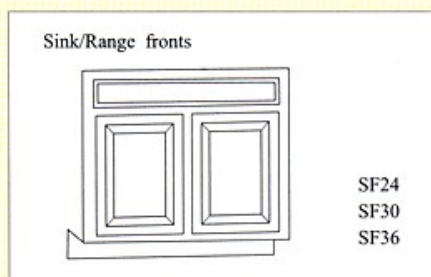



# *Continental Cabinets*

