

HUD Approved Cabinets (General Use)
5% Upgrade for KCMA approved Blum Hardware

All Wood Cabinets

"M" Maple



Features:

- ALL WOOD CONSTRUCTION • 1/2" PLYWOOD SIDES
- 3/4" SOLID MAPLE FACE FRAMES • EURO/CONCEALED HINGE
- 5/8" ADJUSTABLE PLYWOOD SHELVES • DRAWER BOX w/1/2" PLYWOOD SIDES
- EPOXY COATED DRAWER GLIDES • RAISED PANEL MAPLE DOORS
- 4-1/2" TOE SPACE with ALL WOOD TOE KICKS

WALL CABINETS 12" DEEP

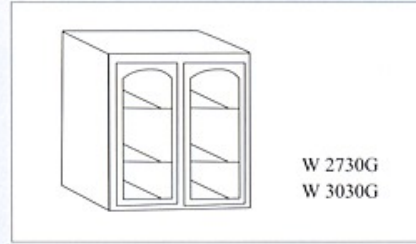
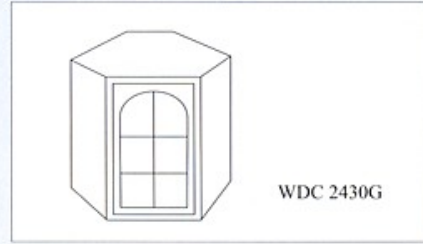
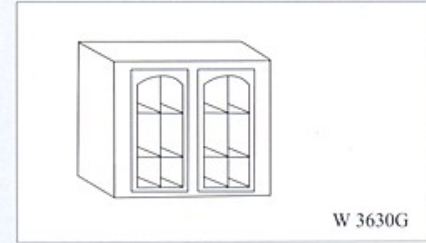
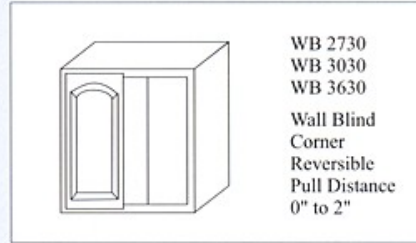
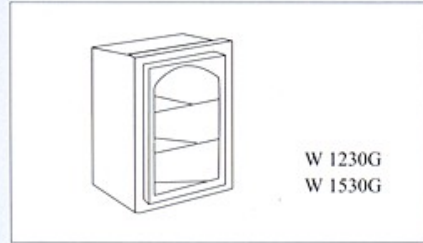
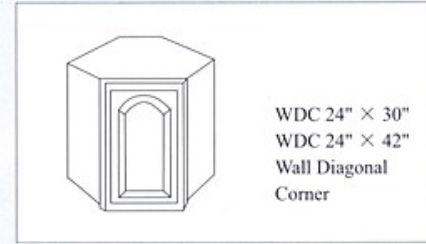
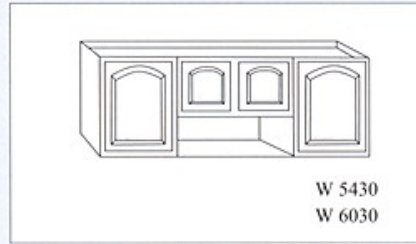
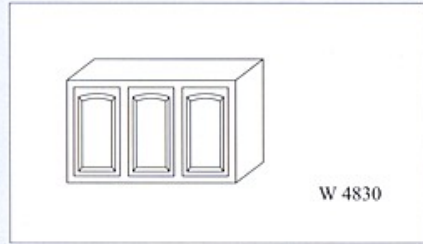
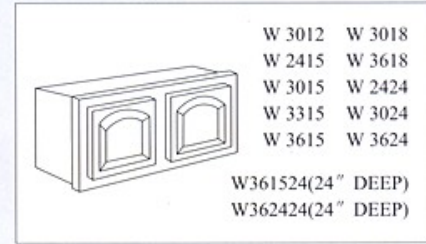
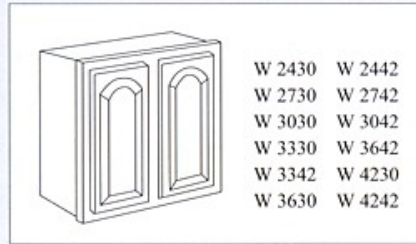
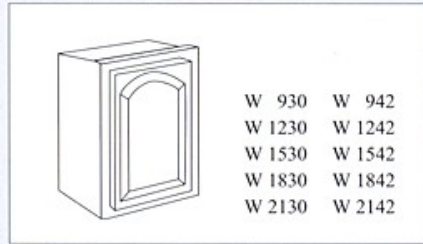

BASE CABINETS 34 - 1/2" HIGH & 24" DEEP

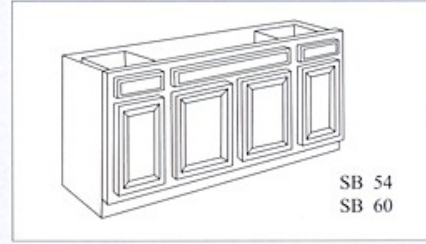
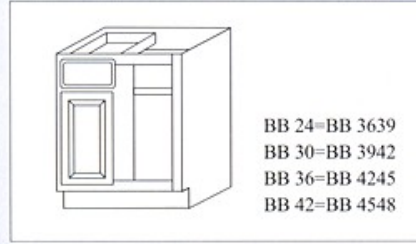
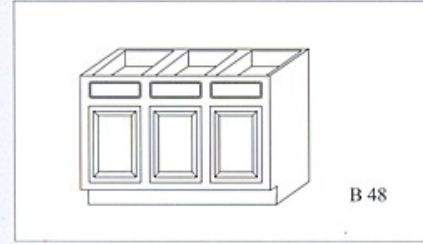
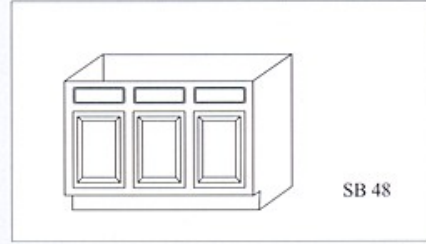
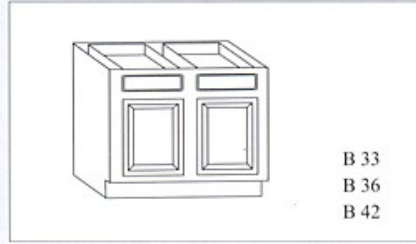
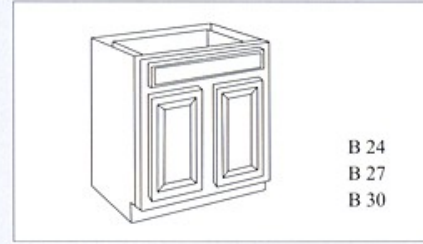
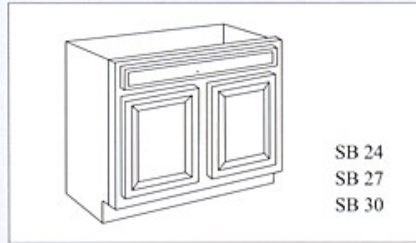
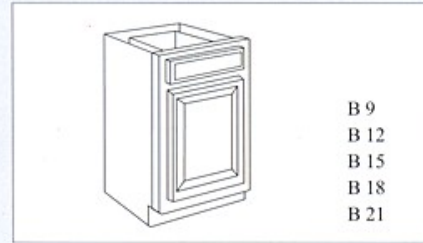

TALL CABINETS (84" HIGH)

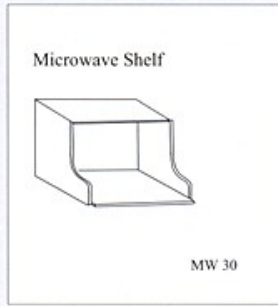
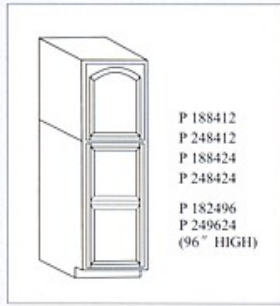

BASE CABINETS 34 - 1/2" HIGH & 24" DEEP

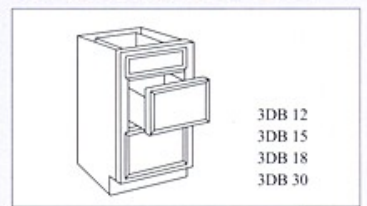

VANITIES

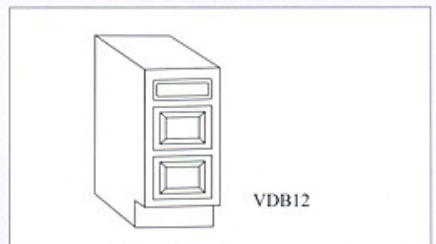
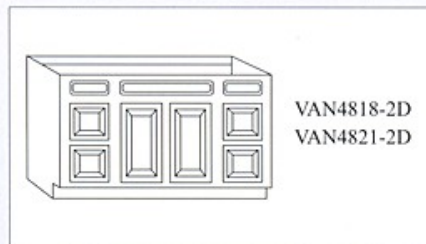
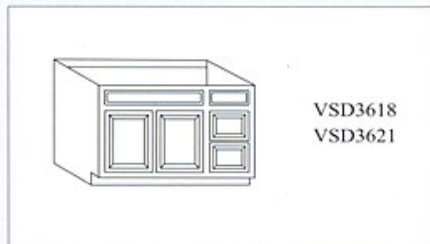
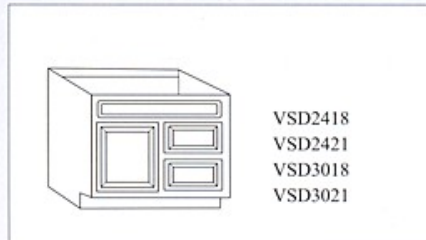
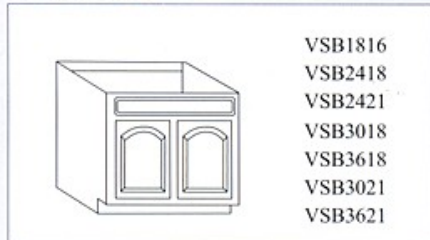

SPECIALTY UNITS

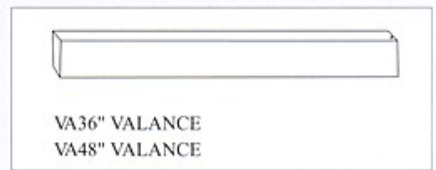
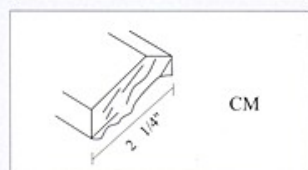
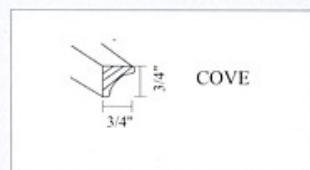
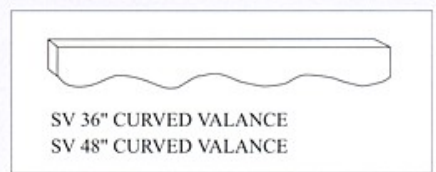
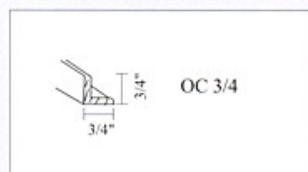
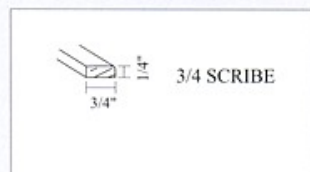
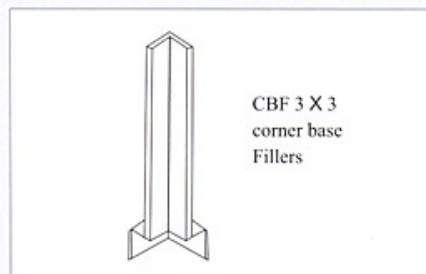
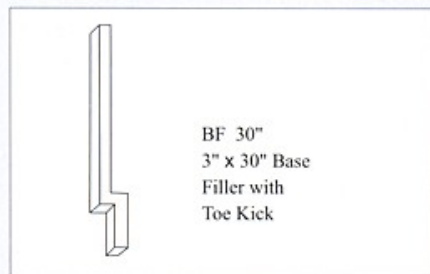
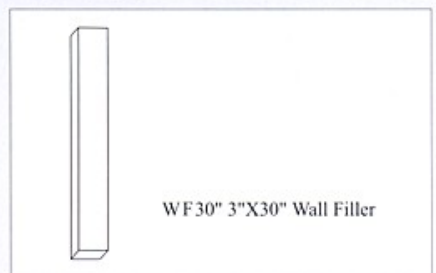
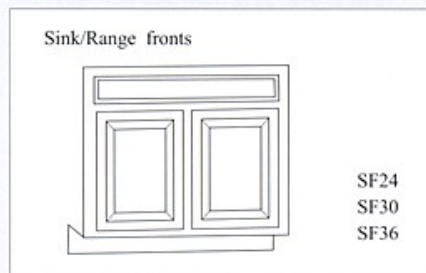

All Wood Cabinets

