

# KCMA APPROVED *ALL WOOD CABINETS*

"A" Premium



## *Features:*

- ALL WOOD CONSTRUCTION • 1/2" PLYWOOD SIDES
- 3/4" RUBBER WOOD FACE FRAMES • EURO/CONCEALED HINGE
- 5/8" ADJUSTABLE PLYWOOD SHELVES • DRAWER BOX w/1/2" PLYWOOD SIDES
- EPOXY COATED DRAWER GLIDES • RAISED PANEL RUBBER WOOD DOORS
- 4-1/2" ALL WOOD TOE KICKS



## WALL CABINETS 12" DEEP

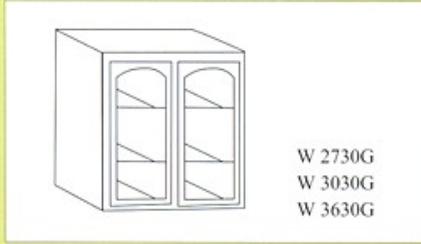
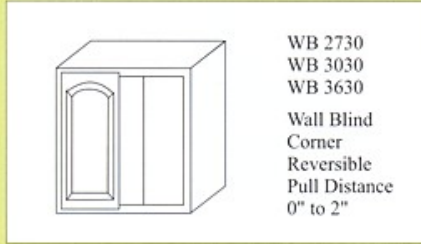
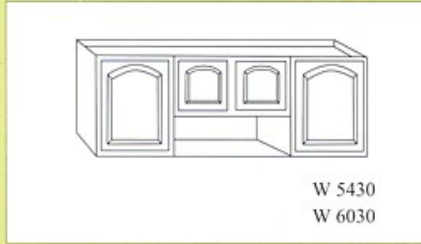
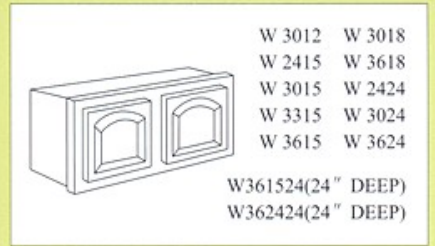
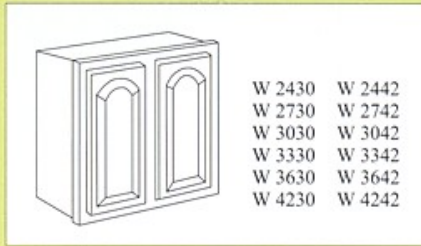
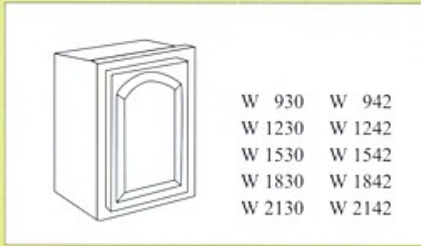

## BASE CABINETS 34 - 1/2" HIGH & 24" DEEP

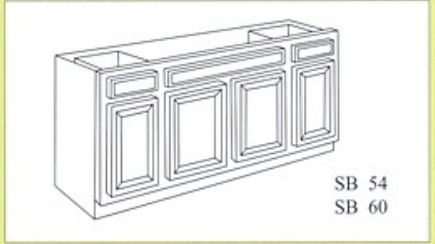
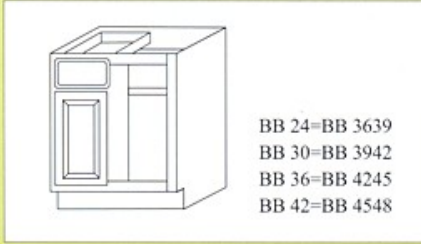
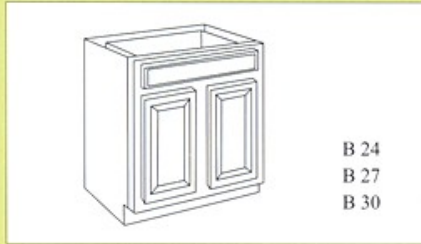
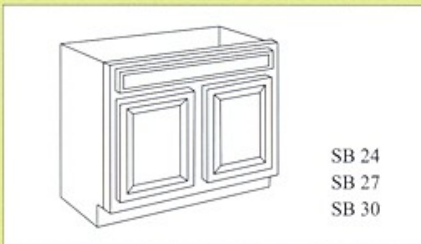
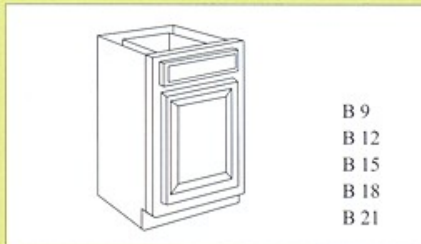

## UTILITY CABINETS

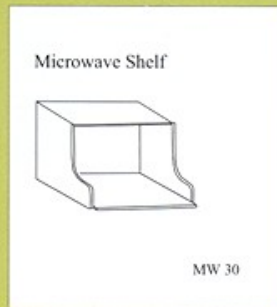
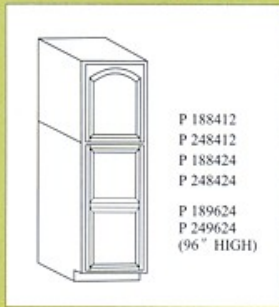

## BASE CABINETS 34 - 1/2" HIGH & 24" DEEP

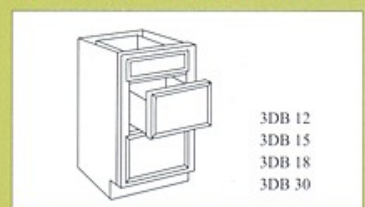

## VANITIES

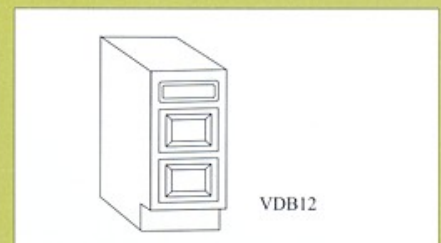
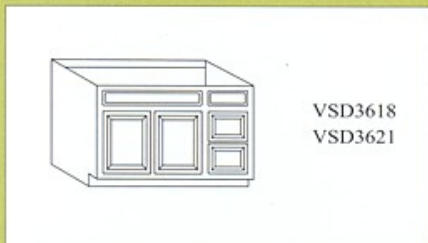
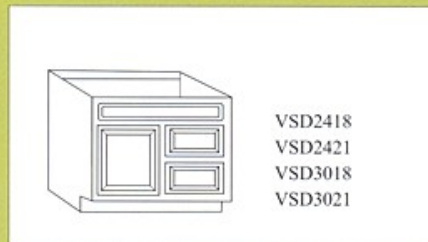
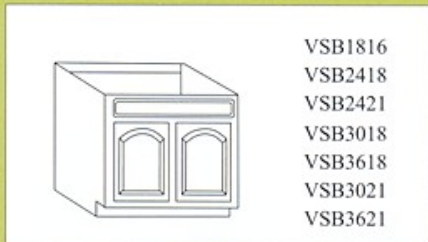

## SPECIALTY UNITS

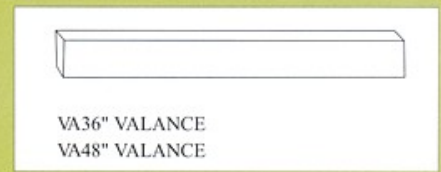
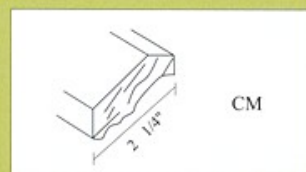
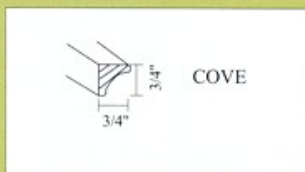
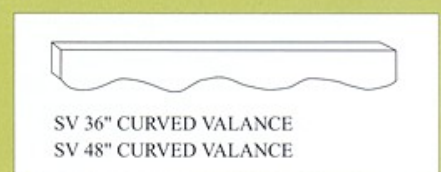
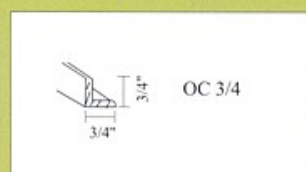
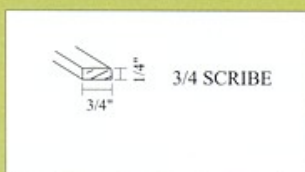
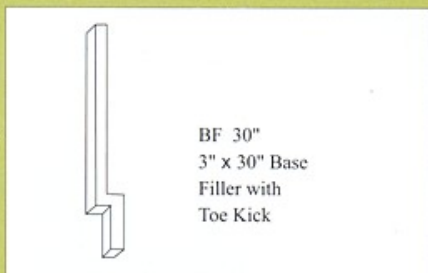
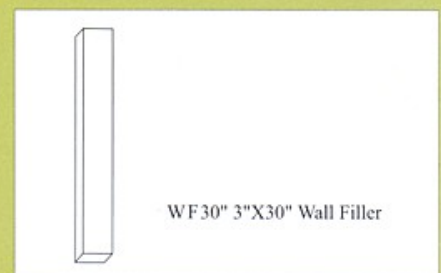
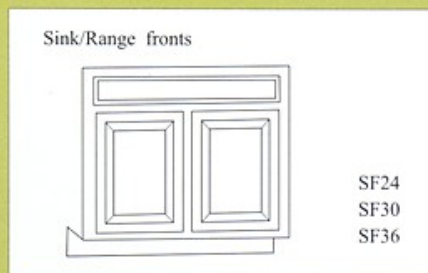



# All Wood Vanities

